

本函檔號: XRL/2011/0294

通告

高鐵香港段 — 連翔道南行綫臨時封閉措施

為配合高鐵香港段項目，港鐵公司將於 2011年11月25日至12月1日 凌晨零時至早上5時30分 進行拆卸 D1 及 T 行車天橋的工程。為減低對路面交通的影響，有關工程將於夜間進行。工程期間須封閉部分連翔道南行路段，前往尖沙咀的車輛須臨時改行麗翔道東行、渡船街南行及廣東道南行（詳情請參閱附圖）。屆時，有關路段將設置適當交通指示牌，指導駕駛人士有關安排。

若上述臨時交通措施帶來任何不便，敬請見諒。如有任何查詢，歡迎致電港鐵工程項目熱綫 2993-3333。

項目傳訊經理

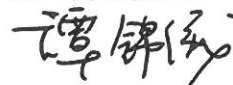

譚錦儀

二零一一年十一月十五日

Our Ref.: XRL/2011/0294
15 November 2011

Notice

Express Rail Link – Temporary Closure of the Section of Lin Cheung Road Southbound

To facilitate the construction of the Express Rail Link, demolition works for D1 & T bridges will be carried out from 25 November to 1 December 2011 from 12:00am to 5:30am. To minimise the impact on road traffic, related works will be carried out at night.

During the works period, a section of Lin Cheung Road southbound will be temporarily closed. Vehicles heading for Tsim Sha Tsui will be temporarily diverted via Lai Cheung Road eastbound, Ferry Street southbound and Canton Road southbound (please refer to the attached drawings for more details). Appropriate signs will be erected to guide motorists.

We apologise for any inconvenience caused. Should you have any enquiries, please contact the MTR Projects Hotline at 2993 3333.

Yours sincerely



Jenny Tam
Projects Communications Manager

圖例 Legends:



臨時封閉路段
Temporary Road Closure



建議行車路線
Suggested Vehicle Route



新建D1 & T替代橋路段
New Replacement D1 & T
Bridges

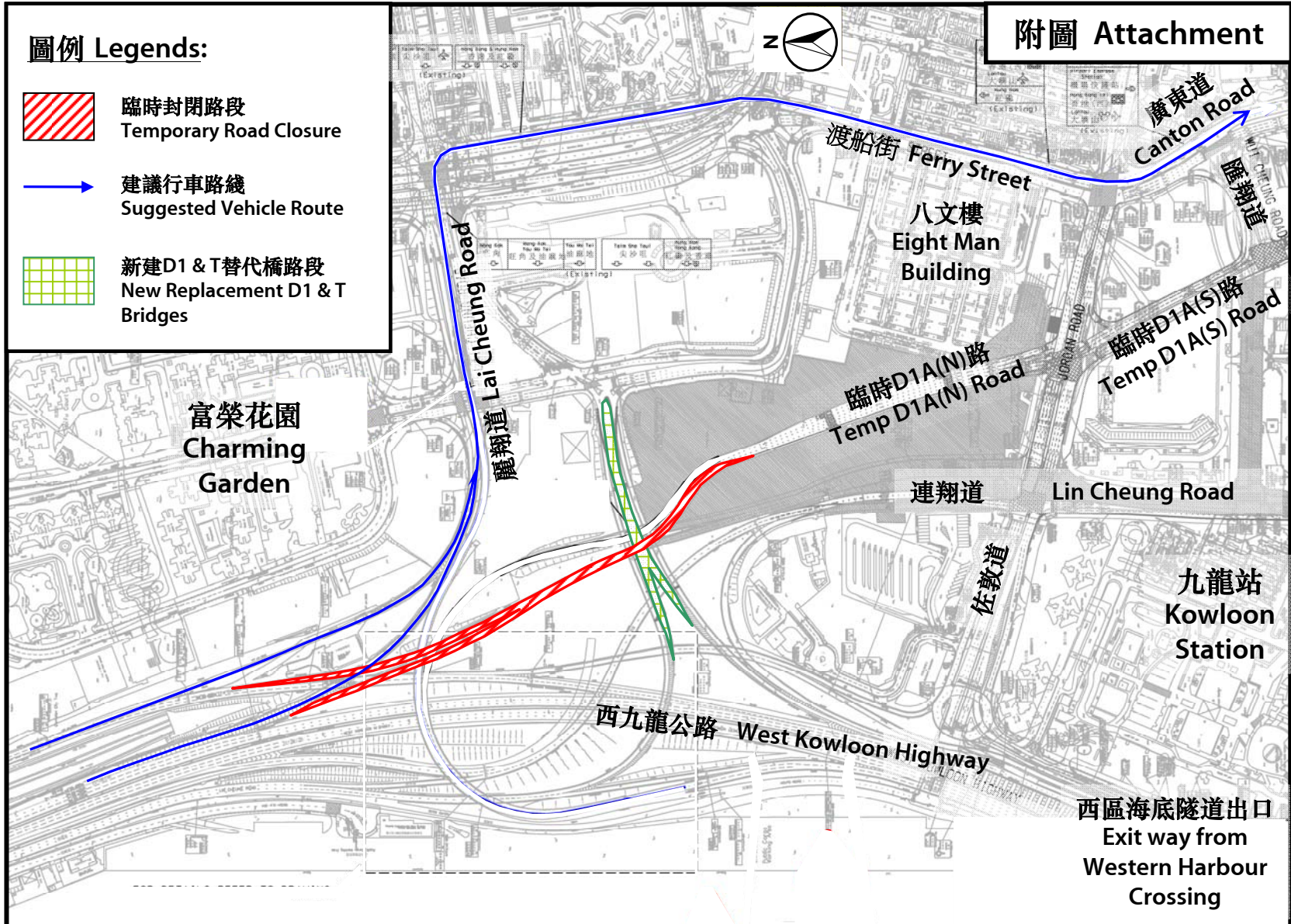

連翔道南行之臨時封閉措施 (由2011年11月25日至12月1日凌晨零時至早上5時30分)
 Temporary closure of the section of Lin Cheung Road Southbound
 (From 25 November to 1 December 2011, 12:00am to 5:30am)